

*Concrete Mixer Supply.com*

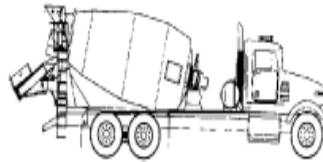

*Mixer Parts*

**CABLES & CONTROLS SECTION**

**Concrete Mixer Supply.Com**

**SECTION 4**

***Mixer Controls,***

***Cables***

***&***

***Accessories***

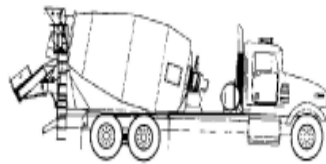

# CABLES & CONTROLS SECTION

Smith Control and Cable Assembly

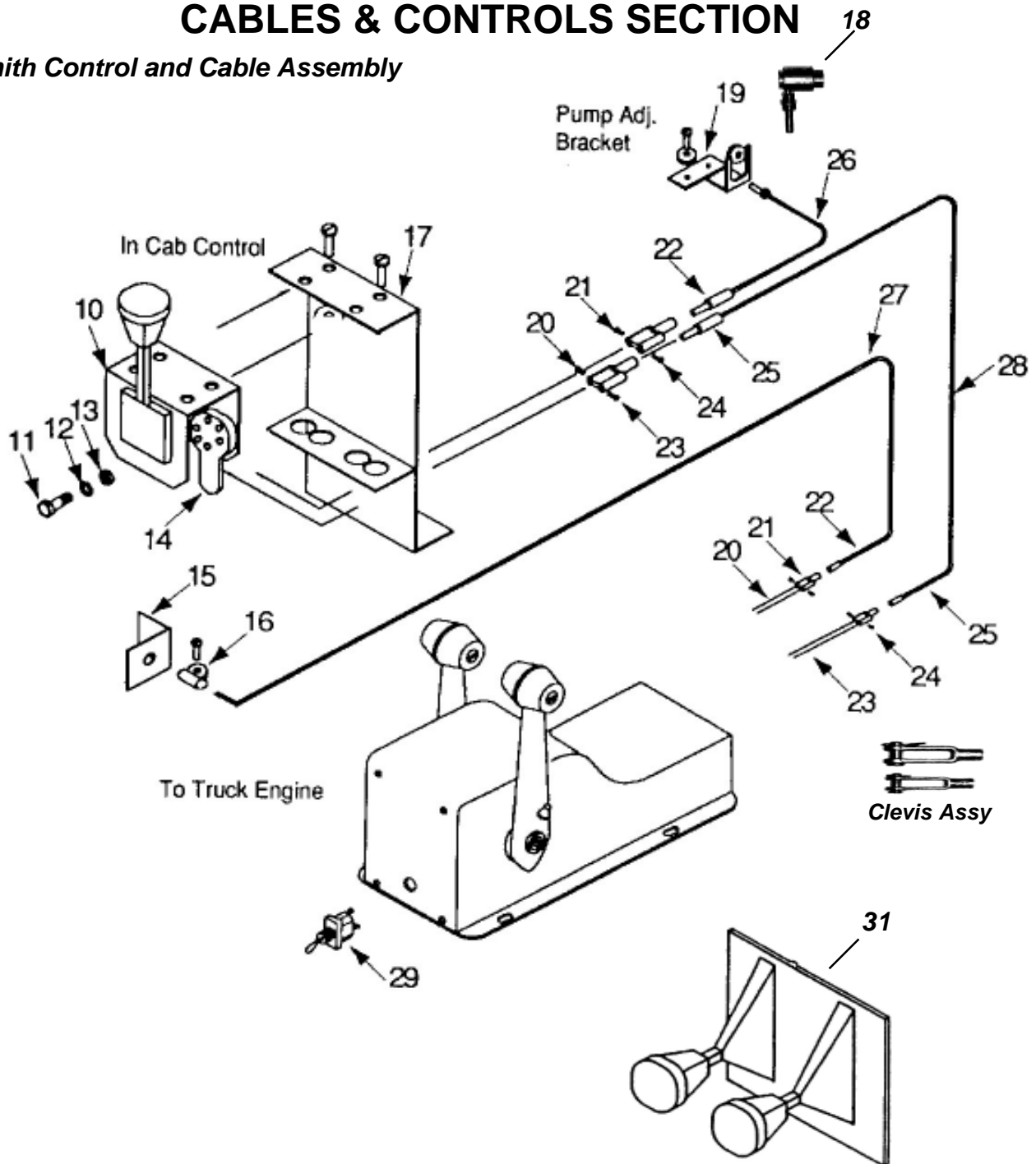

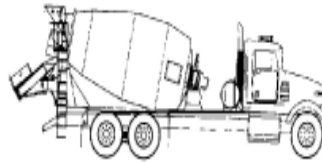

## CABLES & CONTROLS SECTION

### Smith Control and Cable Assembly

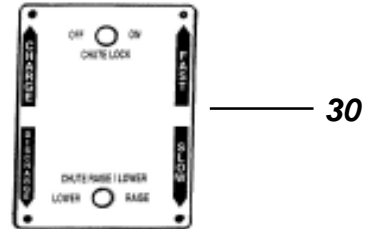
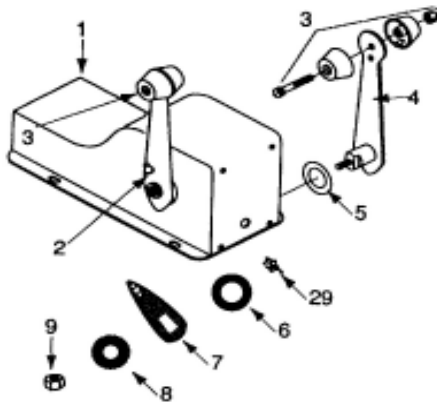

<u>Item #</u>	<u>CMS #</u>	<u>OEM Part#</u>	<u>Description of Part</u>	<u>Qty</u>
1	CON 1022 D	43907000	Control Box Housing Only	1
1	CON 1021 B	40907003	Single Handle Control Box Assy	1
1	CON 1021 A	43906002	Double Handle Control Box Assy	1
2	HW 9262		Grease Zerk	1
3	CON 1039	020.16553	Red Plastic Knob Kit	1
3	CON 1038	020.16552	Black Plastic Knob Kit	1
4	CON 1033	5010884	Handle Assembly (requires 1 or 2)	
5	CON 1036	1050824	Side Plate Washer (requires 1 or 2)	
6	CON 1035	1320441	Rubber Washer (requires 1 or 2)	
7	CON 1034	5011309	Control Lever (requires 1 or 2)	
8	CON 1037	1050503	Fender Washer (requires 1 or 2)	
9	LN 5000		1/2" Locknut (requires 1 or 2)	
10	CON 1008	3113000	Quadco Single Lever Control	1
11	B 1100		1/4" x 1" Hex Bolt	2
12	UW 1000		1/4" Washer	4
13	LN 1000		1/4" Locknut	2
14	CON 1012	3112010	Output Lever	1
15	CON 1043 A	1428000	Throttle Bracket	1
16	CON 1043	0986000	Throttle Stop	1
17	CON 1007	3590001	Quadco Control Mount Stand -Cab	1
18	CON 1042		1/4" Pump Swivel	1
19	CON 2001	2833000	Cable Pump Bracket	1
20-22	CON 1019	020.00800	1/4" Clevis Assembly	1
23-25	CON 1018	020.00833	5/16" Clevis Assembly	1
26	CON 1072	4137011	1/4" x 3" Throw x 14Ft Cable	1
27	CON 1020	8687	30' Throttle Cable - Bulkhead one end	1
28	CON 1095	2131018	5/16" x 3" Throw x 21 Foot Control Cable	1
29	CSW 1001	26602	Momentary Switch Sealed no leads	
29	CSW 1000	3261000	On/Off Switch Sealed no leads	
30	CON 1041 H	43907010	Control Box Decal	1
31	CON 1009	3112000	Quadco Rear Lever Control Double	1
31	CON 1009A	3249000	Quadco Rear Lever Control Single	1

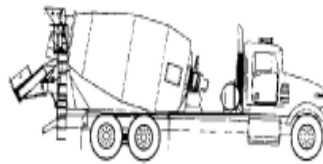

## CABLES & CONTROLS SECTION

**Con1021  
McNeilus Universal  
3" or 4" Rear  
Cable Control**

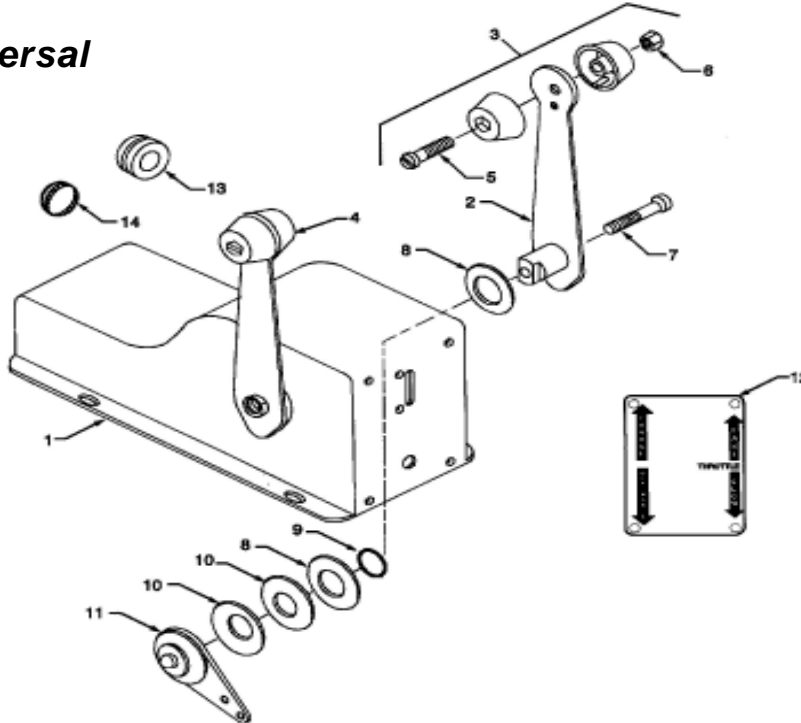

<u>Item #</u>	<u>CMS #</u>	<u>OEM #</u>	<u>Description</u>
1	CON 1021	280.153880	Control Box - Steel
1	CON 1023	153880AL	Control Box - Aluminum
1	CON 1022E	320.153890	Box Weldment
2	CON 1026	020.153898	Handle
3	CON 1038	020.16552	Green Knob Kit
4	CON 1039	020.16553	Red Knob Kit
5	CON 1038A	020.100710	5/16-18x1-1/2" Allen Hd
6	LN 2000	020.100527	5/16-18 Locknut
7	CON 1027	020.100661	5/16-18 x 2" Allen Hd
8	CON 1028	020.153883	Lever Shim
9	CON 1031	100.153899	O-Ring Seal
10	CON 1032	020.153895	Bevel Washer
11	CON 1030	020.153888	Throttle Lever
11	CON 1029	020.153889	Drum Control Lever
12	CON 1041	780.215078	Placard
13	CON Grom	120.115163	Rubber Grommet
14	CON Plug	040.115953	Hole Plug

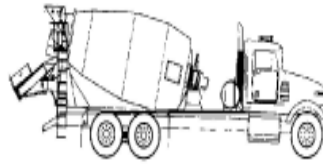

## CABLES & CONTROLS SECTION

Con1021  
McNeilus Universal  
3" or 4" Rear  
Cable Control

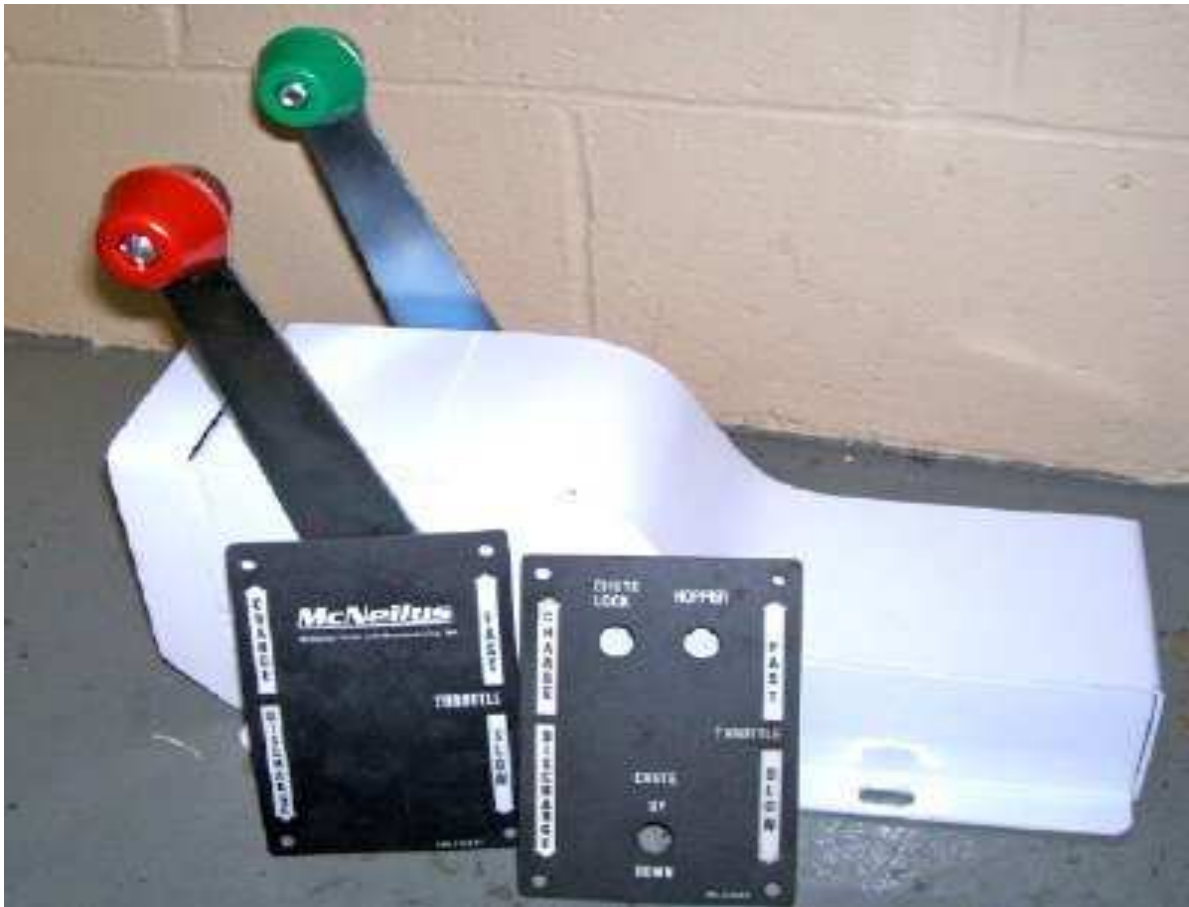

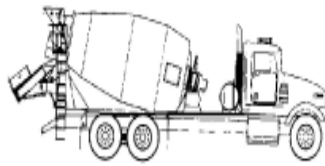

## CABLES & CONTROLS SECTION

### Quadco Controls Rex & Smith

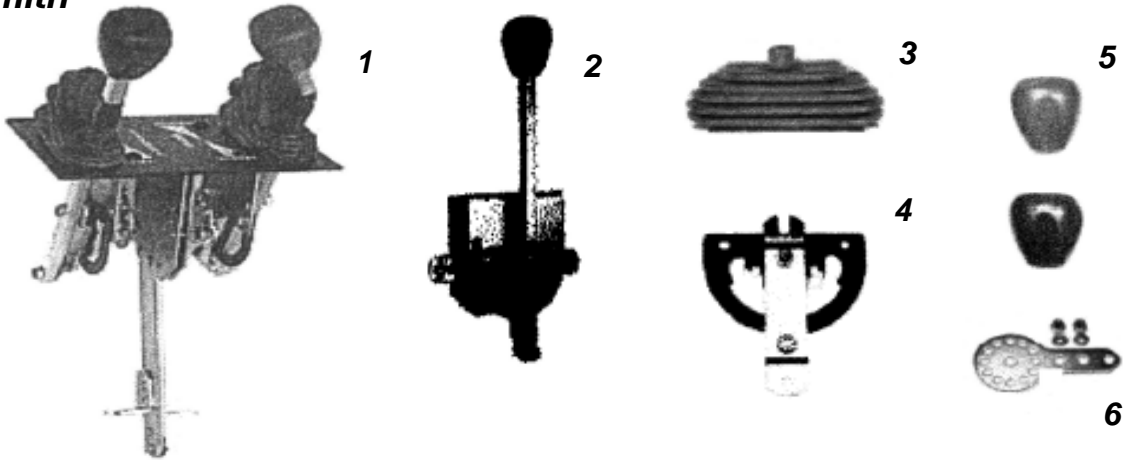

<u>Item #</u>	<u>CMS #</u>	<u>OEM Part#</u>	<u>Description of Part</u>
1	CON 1009	3112000	Quadco Double Lever Control
1	CON 1009 A	3249000	Quadco Single Lever Control
2	CON 1008	3113000	Quadco Cab Control Lever Assy
3	CON 1017	3112001	Rubber Boot
4	CON 1011	3112005	Friction Assembly
4	CON 1010	3002007	Friction Assembly with Detent
5	CON 1015	3112008	Black Knob
5	CON 1016	3112009	Red Knob
6	CON 1012	3112010	Lever

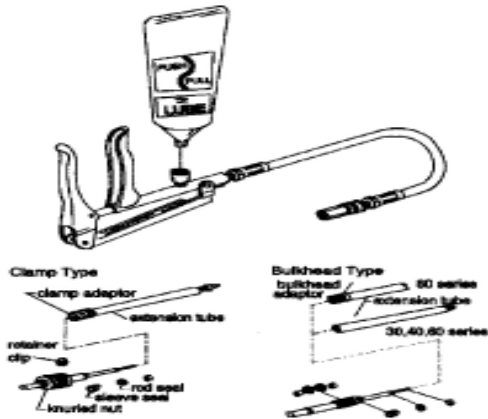

### PUSH PULL CABLE LUBRICATION

<u>CMS #</u>	<u>OEM #</u>	<u>Description</u>
CON 1049	780.00861	Pressure Gun
CON 1050	780.00831	1/4" Series Adaptor
CON 1051	780.00832	5/16" Series Adaptor
CON 1052	780.00804	Tubes of Lubricant

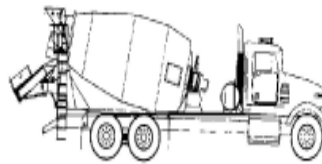

## CABLES & CONTROLS SECTION

### Electric Pump Control Assembly London & Smith

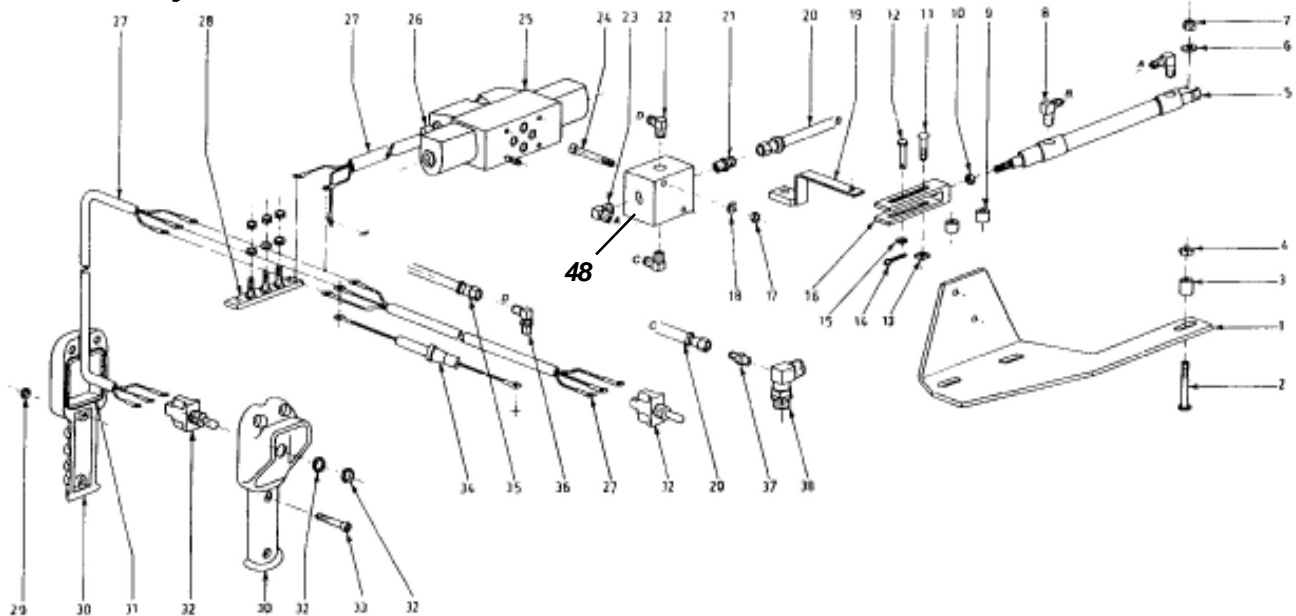

<u>Item #</u>	<u>CMS #</u>	<u>OEM Part#</u>	<u>Description of Part</u>	<u>Qty</u>
1	ELCON 1002	31697001B	Mounting Bracket	1
2	B2200		5/16 x 2" Machine Screw	1
3	ELCON 1002 A	30299	Spacer	1
4	ELCON 1015		5/16 Hex Jam Nut	1
5	ELCON 1000	30228	Cylinder	1
6	UW 2000		5/16 Flat Washer	1
7	LN 2000		5/16 Locknut	1
8	ELCON 1010	30267	90 Deg Elbow Connector	1
9	ELCON 1002 A	30299	Spacer	2
10	ELCON 1015		5/16 Hex Jam Nut	1
11-12	ELCON 1006	30244	3/16 x 1" Clevis Pin	2
13 & 15	UW 1000		1/4" Flat Washer	2
14	ELCON 1004		Cotter Pin	2
16	ELCON 1012	30118A	Control Clevis	1
17	LN 1000		1/4" Locknut	2
18	UW 1000		1/4" Washer	2
19	ELCON 1003	33506	Pump Control Lever	1
20	ELCON 1011	30543001	16" Hose Assembly	2
21	ELCON 1005	22121	Fitting	1
22	ELCON 1008	30247	Fitting	2
23	ELCON 1009	30249	Fitting	1

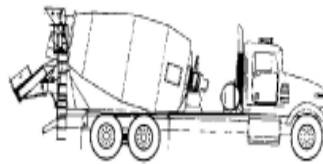

## CABLES & CONTROLS SECTION

### Electric Pump Control Assembly London & Smith

<u>Item #</u>	<u>CMS #</u>	<u>OEM Part#</u>	<u>Description of Part</u>	<u>Qty</u>
24	ELCON 1019		1/4 x 1-3/4 Allen Head	2
25	ELCON 1018	30230	Valve	1
26	ELCON 1020	30300	Connector	1
27	ELC018-3	24145	Cable 18-3	Ref
28	ELCON 1021	27652	Terminal Block 3 Post	1
29	CSW 1006C		10-24 Hex Nut (comes with handle)	4
30	CON 2000	26680-C	Yellow Handle - Single Switch	1
31	CON 2000 A	27257	O'Ring	1
32	CSW 1001	26602	Toggle Switch - Momentary Sealed	2
33	CSW 1006B		10-24 x 1 Allen Head (comes with handle)	4
34	ELC2079	24193	In Line Fuse	1
35	ELCON 1013	30250001	19" Hose Assembly	2
36	ELCON 1007	30245	O'Ring Elbow Fitting with Restriction	1
37	ELCON 1022	30248	Fitting	1
38	ELCON 1023	2580000	O'ring Fitting with Tapped Hole	1
39	CSW 1006	26680060	Red Handle (no switches)	1
40	CSW 1006 A	26680013	Red Handle Decal	1
41	CSW 1009	26680010	Red Handle Assy 3 Switch Cole Hersee	
42	CSW 1009 A	520-010015	Red Handle Assy 6 Switch no Cole Hersee	
43	CSW 1009 B	5500212	Red Handle Assy 6 Switch w/ Cole Hersee	
44	CSW 1015 A	50000096	Cable Wrap Bracket	1
45	CSW 1015	31285053	Red Handle Mount Bracket	1
46	CSW 1015 B		Red Handle Strap Assembly	1
47	CSW 1009 C	27255	Plastic Clip (Holds Red Handle)	2
48	ELCON 1002B	30231	Sub Plate, Valve Mounting	1

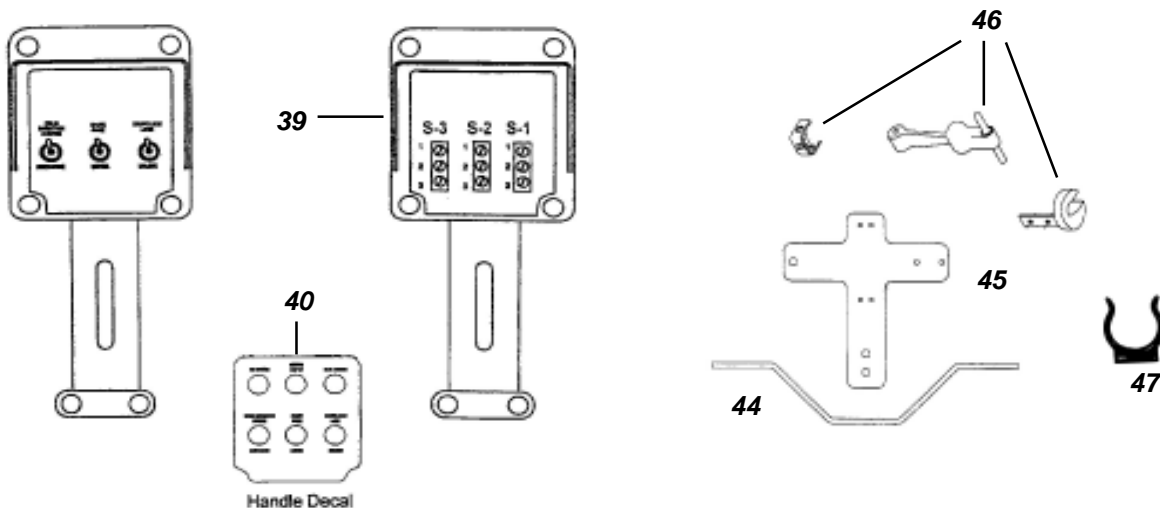



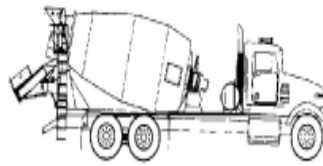

## CABLES & CONTROLS SECTION

**ELCON1018  
D03 VALVE**

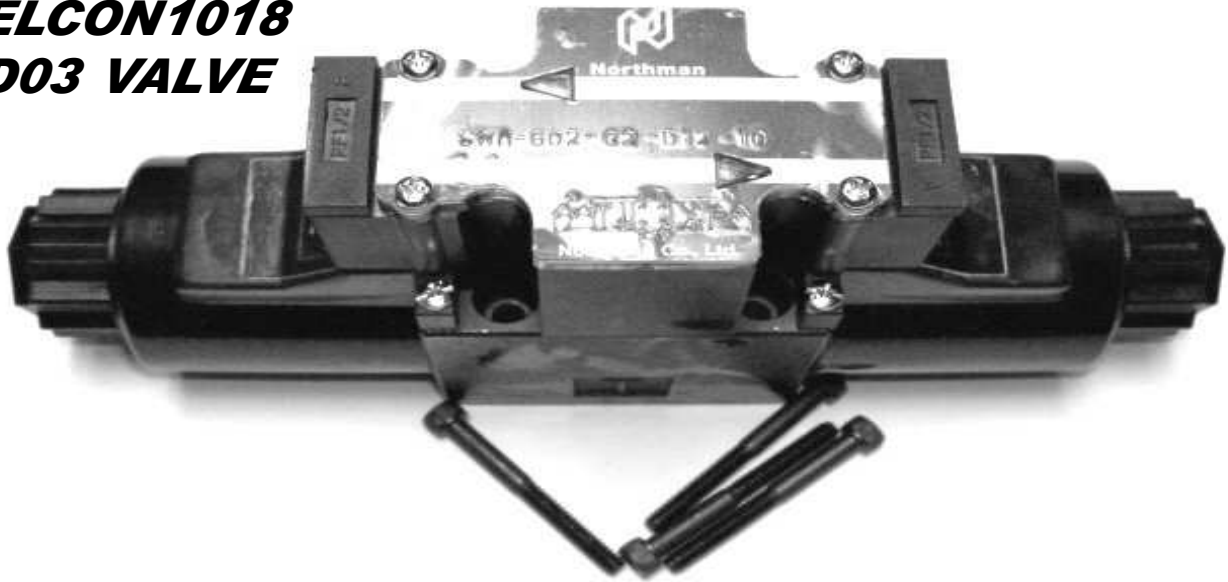

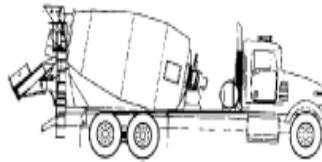

## CABLES & CONTROLS SECTION

### McNeilus Cables

<u>CMS #</u>	<u>OEM Part#</u>	<u>Description of Part (OAL=Overall Length)</u>
CON0995	380.215810	1/4" Ends-4" Throw-Double Nut-OAL 120" or 10'
CON0996	380.215811	1/4" Ends-4" Throw-Double Nut-OAL 132" or 11'
CON0997	380.215812	1/4" Ends-4" Throw-Double Nut-OAL 144" or 12'
CON0998	380.215813	1/4" Ends-4" Throw-Double Nut-OAL 156" or 13'
CON0999	380.215814	1/4" Ends-4" Throw-Double Nut-OAL 168" or 14'
CON 1000	380.215815	1/4" Ends-4" Throw-Double Nut-OAL 180" or 15'
CON1000A	380.215816	1/4" Ends-4" Throw-Double Nut-OAL 196" or 16'
CON 1001	380.215217	1/4" Ends-4" Throw-Double Nut-OAL 204" or 17'
CON 1002	380.215818	1/4" Ends-4" Throw-Double Nut-OAL 216" or 18'
CON 1003	380.215819	1/4" Ends-4" Throw-Double Nut-OAL 228" or 19'
CON 1004	380.215820	1/4" Ends-4" Throw-Double Nut-OAL 240" or 20'
CON 1005	380.215821	1/4" Ends-4" Throw-Double Nut-OAL 252" or 21'
CON 1006	380.215822	1/4" Ends-4" Throw-Double Nut-OAL 264" or 22'
CON 1104	380.215823	1/4" Ends-4" Throw-Double Nut-OAL 276" or 23'
CON 1105	380.215824	1/4" Ends-4" Throw-Double Nut-OAL 288" or 24'
CON 1106	380.215825	1/4" Ends-4" Throw-Double Nut-OAL 300" or 25'
CON1107	380.215826	1/4" Ends-4" Throw-Double Nut-OAL 312" or 26'
CON1108	380.215827	1/4" Ends-4" Throw-Double Nut-OAL 324" or 27'
CON1109	380.215828	1/4" Ends-4" Throw-Double Nut-OAL 336" or 28'

### Universal Throttle Cables

<u>CMS#</u>	<u>OEM Part#</u>	<u>Description of Part (OAL=Overall Length)</u>
CON 1020	8687	1/4" End-3" Throw-Double Nut 1 End-OAL 360" or 30'
CON 1020 A	8687 IBC	1/4" End-3" Throw-Double Nut 1 End-OAL 500"
CON 1066	5010972	1/4" End-4" Throw-Double Nut 1 End-OAL 360" or 30'
CON1066A		1/4" End-4" Throw-Double Nut 1 End-OAL 396" or 33'

### Smith Control Cables (Cab to Pump Cable)

<u>CMS #</u>	<u>OEM Part#</u>	<u>Description of Part (OAL=Overall Length)</u>
CON 1061	4137004	1/4" End-3" Throw-Double Nut Ends-OAL 48" or 4'
CON 1062	4137005	1/4" End-3" Throw-Double Nut Ends-OAL 60" or 5'
CON 1063	4137001	1/4" End-3" Throw-Double Nut Ends-OAL 72" or 6'
CON 1064	4137002	1/4" End-3" Throw-Double Nut Ends-OAL 84" or 7'
CON 1065	4137003	1/4" End-3" Throw-Double Nut Ends-OAL 96" or 8'
CON 1067	4137006	1/4" End-3" Throw-Double Nut Ends-OAL 108" or 9'
CON 1068	4137007	1/4" End-3" Throw-Double Nut Ends-OAL 120" or 10'
CON 1069	4137008	1/4" End-3" Throw-Double Nut Ends-OAL 132" or 11'
CON 1070	4137009	1/4" End-3" Throw-Double Nut Ends-OAL 144" or 12'

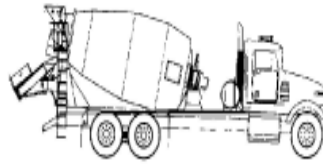

## CABLES & CONTROLS SECTION

Proper Measurement of Cables

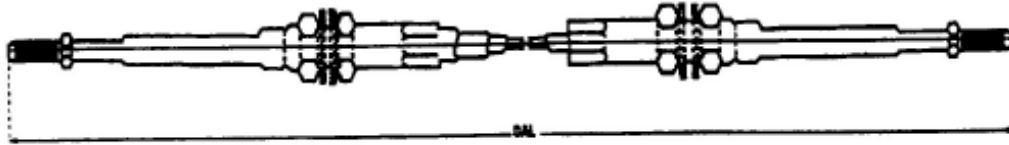

### Smith Control Cables (1/4" Ends 3" Throw Cab to Pump Cable)

<u>CMS #</u>	<u>OEM Part#</u>	<u>Description of Part (OAL=Overall Length)</u>
CON 1072	4137011	1/4" End-3"Throw-Double Nut Ends-OAL 168" or 14'
CON 1073	4137012	1/4" End-3"Throw-Double Nut Ends-OAL 180" or 15'
CON 1074	4137013	1/4" End-3"Throw-Double Nut Ends-OAL 192" or 16'
CON 1075	4137014	1/4" End-3"Throw-Double Nut Ends-OAL 204" or 17'
CON 1076	4137015	1/4" End-3"Throw-Double Nut Ends-OAL 216" or 18'
CON 1077	4137016	1/4" End-3"Throw-Double Nut Ends-OAL 228" or 19'
CON 1078	4137017	1/4" End-3"Throw-Double Nut Ends-OAL 240" or 20'
CON 1079	4137018	1/4" End-3"Throw-Double Nut Ends-OAL 252" or 21'
CON 1080	4137019	1/4" End-3"Throw-Double Nut Ends-OAL 264" or 22'
CON 1081	4137020	1/4" End-3"Throw-Double Nut Ends-OAL 276" or 23'
CON 1081288	00824	1/4" End-3"Throw-Double Nut Ends-OAL 288" or 24'
CON 1082	4137023	1/4" End-3"Throw-Double Nut Ends-OAL 360" or 30'

### Smith Control Cables (5/16" Ends 3" Throw- Rear Control Box to Cab )

<u>CMS #</u>	<u>OEM Part#</u>	<u>Description of Part (OAL=Overall Length)</u>
CON 1087	2131010	5/16" End-3"Throw-Double Nut Ends-OAL 156" or 13'
CON 1088	2131011	5/16" End-3"Throw-Double Nut Ends-OAL 168" or 14'
CON 1089	2131012	5/16" End-3"Throw-Double Nut Ends-OAL 180" or 15'
CON 1090	2131013	5/16" End-3"Throw-Double Nut Ends-OAL 192" or 16'
CON 1091	2131014	5/16" End-3"Throw-Double Nut Ends-OAL 204" or 17'
CON 1092	2131015	5/16" End-3"Throw-Double Nut Ends-OAL 216" or 18'
CON 1093	2131016	5/16" End-3"Throw-Double Nut Ends-OAL 228" or 19'
CON 1094	2131017	5/16" End-3"Throw-Double Nut Ends-OAL 240" or 20'
CON 1095	2131018	5/16" End-3"Throw-Double Nut Ends-OAL 252" or 21'
CON 1096	2131019	5/16" End-3"Throw-Double Nut Ends-OAL 264" or 22'
CON 1097	8488	5/16" End-3"Throw-Double Nut Ends-OAL 276" or 23'
CON 1098	2131020	5/16" End-3"Throw-Double Nut Ends-OAL 288" or 24'
CON 1099	2131021	5/16" End-3"Throw-Double Nut Ends-OAL 300" or 25'

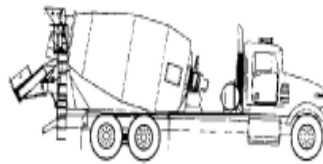

## CABLES & CONTROLS SECTION

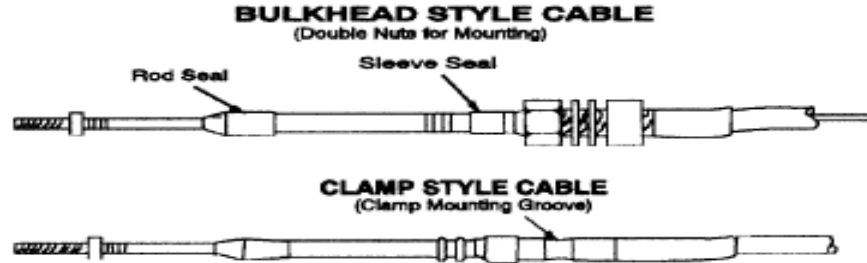

### Challenge Control Cables (5/16 Ends 4" Throw )

<u>CMS #</u>	<u>OEM Part#</u>	<u>Description of Part (OAL=Overall Length)</u>
CON 1083	5010941	5/16" End-4"Throw-Double Nut Ends-OAL 228" or 19'
CON 1084	5010943	5/16" End-4"Throw-Double Nut Ends-OAL 252" or 21'
CON 1085	5010944	5/16" End-4"Throw-Double Nut Ends-OAL 264" or 22'
CON 1086	5010945	5/16" End-4"Throw-Double Nut Ends-OAL 288" or 24'

### Rex Control Cables (3/16 Ends 3" Throw Clamp Style )

<u>CMS #</u>	<u>OEM Part#</u>	<u>Description of Part (OAL=Overall Length)</u>
CON 1057 A	102-7245-4	3/16" End- 3"Throw-Clamp-OAL 274"
CON 1057	102-7245-5	3/16" End- 3"Throw-Clamp-OAL 292"
CON 1057 B	102-7245-6	3/16" End- 3"Throw-Clamp-OAL 310"
CON 1058	102-7245-7	3/16" End- 3"Throw-Clamp-OAL 328"
CON 1059	102-7245-9	3/16" End- 3"Throw-Clamp-OAL 340"

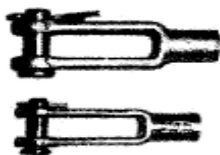

CON 1018 5/16" Clevis Assy  
CON 1019 1/4" Clevis Assy

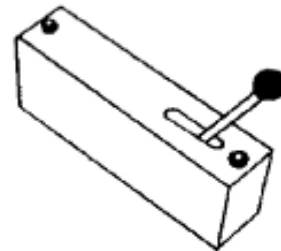

CON 1024 MTM Cab Control



CON 1042 Pump Swivel

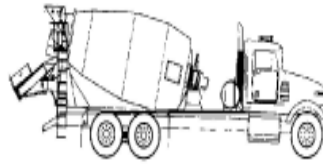

### CABLES & CONTROLS SECTION

**SMITH CAB CABLE CONTROL  
MANUAL VALVE Assembly**

**CMS#  
C 1008 A  
Cable Control Valve  
Cab Mounting Stand**

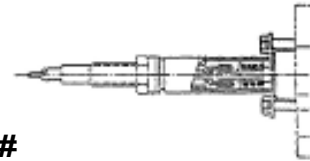
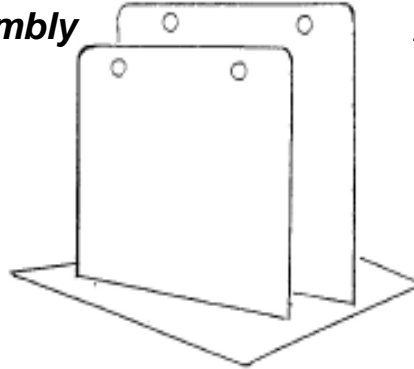
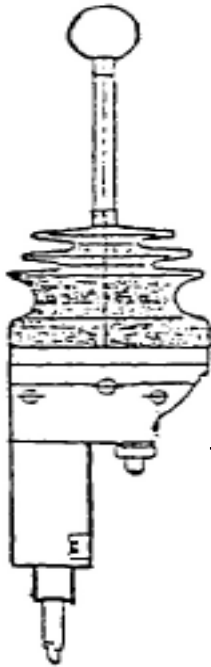

**CMS#  
C 1008 B  
Cable Control Valve  
Cab Mounted**

**CMS#  
C 1006  
Valve Connect Kit  
Attaches to Back End of  
Manual on Rear Pedestal**

**CMS#**

**C 1005 Single Acting  
Cable Control Valve  
Mounted on Rear  
Pedestal**

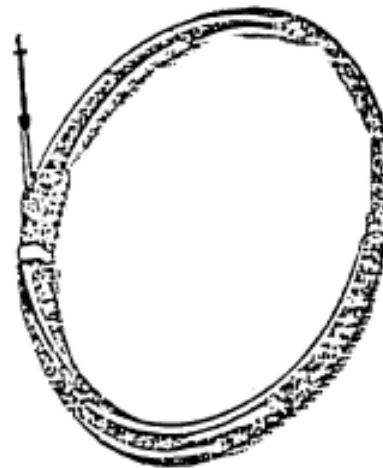
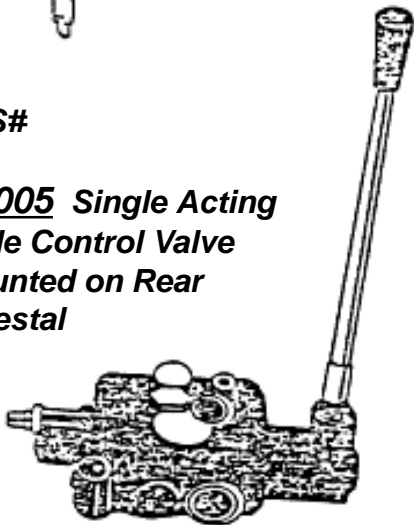

**CMS#  
C 1020 Valve Cable 252"  
C 1020 B Valve Cable 312"**

**C 1007 Double Acting  
Cable Control Valve  
Mounted on Rear  
Pedestal**

Concrete Mixer Supply.com

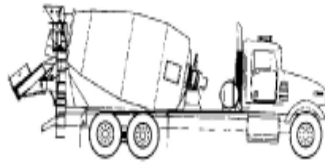

Mixer Parts

CABLES & CONTROLS SECTION

**MC-40000-41**

**6 Switch Handle**



[www.concretemixersupply.com](http://www.concretemixersupply.com)

4-14

877-254-0715



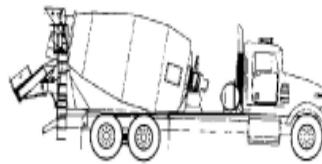

## CABLES & CONTROLS SECTION

### *London Control Handles*

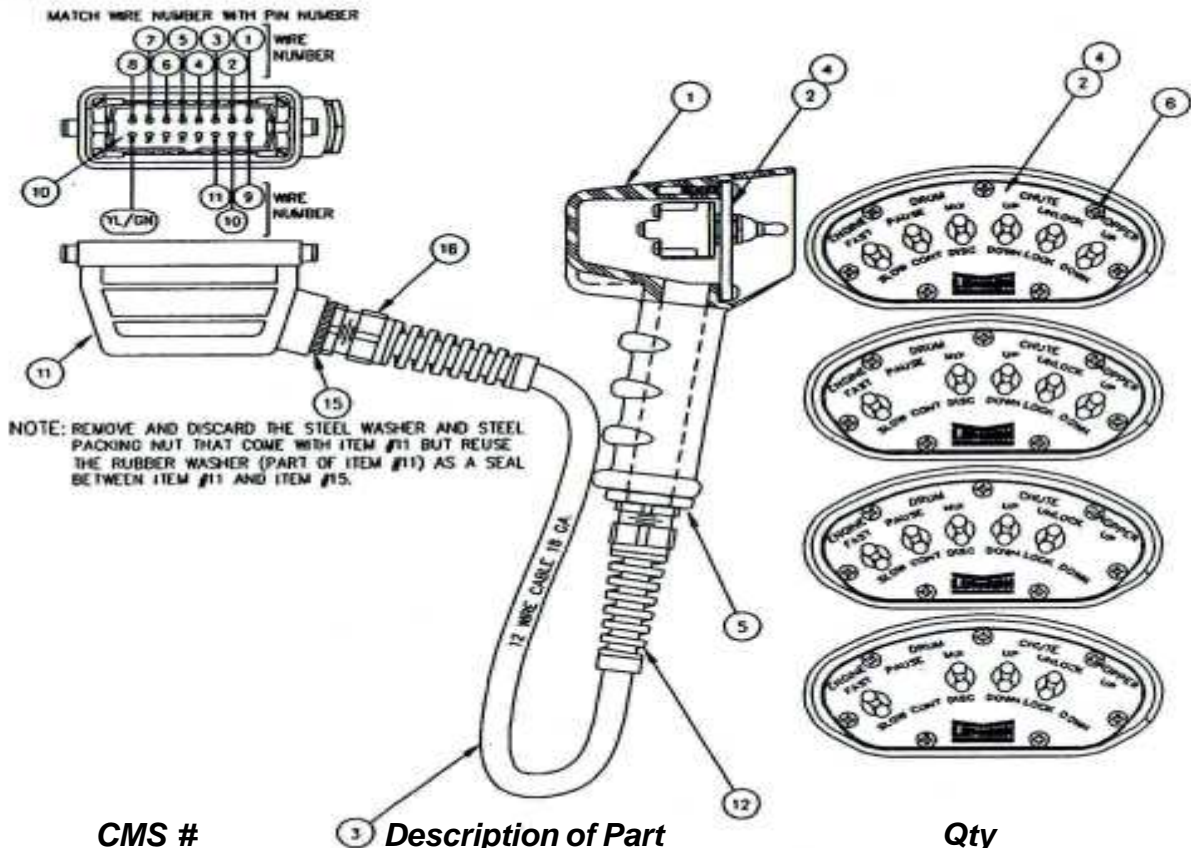

<u>Item#</u>	<u>CMS #</u>	<u>Description of Part</u>	<u>Qty</u>
1	MC-39741	Multi Switch Yellow Handle	1
2	MB-39739	Multi Switch Plate	1
2	MB-39739A	Switch Plate Decal	1
3	ELCON18-12	Electric Cable 12 Wire 18ga	20ft
4	MB-39740	Face Plate Gasket	1
5	HH-01185-005	Reducer 3/4-1/2 NPT Black	1
6	HH-00455-007	Steel Screw #6-3/4"	7
7	MA-38416	Micro Switch	
8	MA-26602	Micro Switch Momentary (CSW1001)	
9	CSW1001A	Rubber Boot - Switch	
10	MA-39997	Male Plug	
11	MA-39999	Cover Plug Mount	
12	HH-01224-012	Flex Cord Grip 1/2	
15	HH-01245-013	Reducer Bushing	

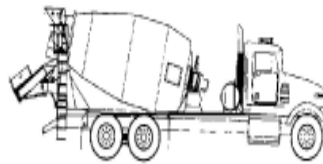

**CABLES & CONTROLS SECTION**

**London Yellow Handle  
& Cable Assembly**

**CON2000 - Handle Blank  
CON-2000A Single Switch  
CON-2000B Double Switch**



**Single or Double Switch**

Flex Nut



**Flex Strain Relief  
CON2000C**

**Handle Decals  
MA-38422A**

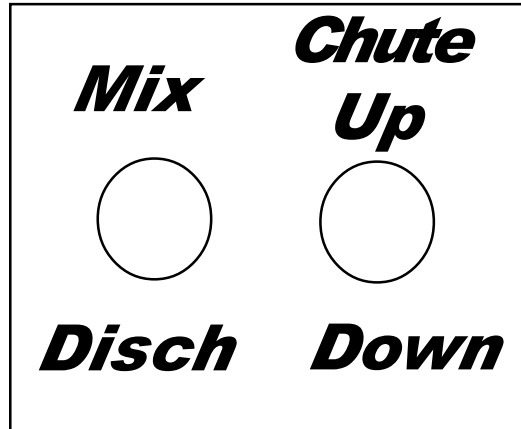

**MA-38422B**

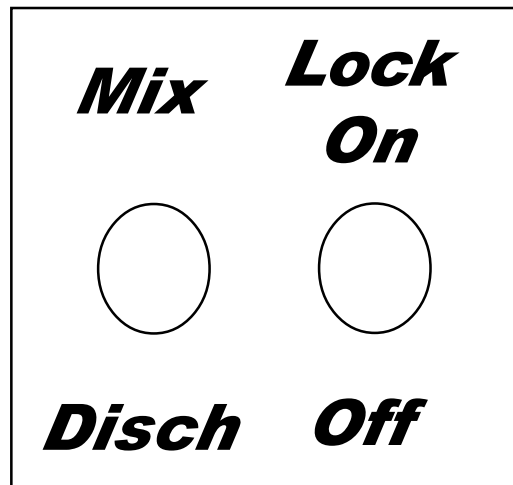

**MA-38422C**

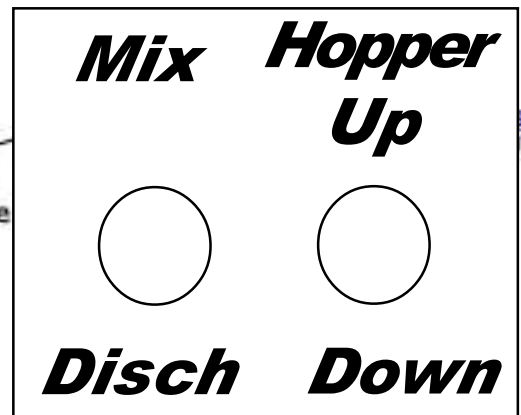



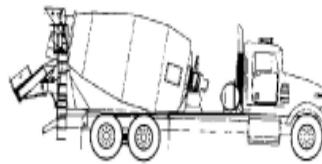

## CABLES & CONTROLS SECTION

### *Rex Controls*



Part Number	Related Parts & Information
102-11714-01	Swivel . . . . . 102-11714-13 Knob . . . . . 112-10130-44
102-10292-01	Red Knob . . . . . 00406 Green Knob . . . . . 00407 Throttle Lever . . . 102-07240-19 Roller Guide . . . . 102-09941-11 Clutch Lever Kit . . 102-09941-13 Clutch Shaft . . . . 102-09941-14 Base & Brake Assy . 102-09941-16 Brake . . . . . 102-09941-23 Clutch Arm . . . . . 102-09942-11 Throttle Lever Kit . 102-09941-12
102-09941-12	Knob . . . . . 00407 Brake . . . . . 102-09941-23 Throttle Lever . . . 102-07240-19



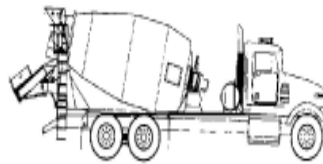

## CABLES & CONTROLS SECTION

### Rex Controls



Part Number	Related Parts & Information
102-11697-01	Throttle Input Lever ..... 102-11697-02 Pump Input Lever ..... 102-11697-12 Pivot Throttle ..... 112-10130-40 Red Knob ..... 112-10130-43 Output Lever ..... 112-10130-45 Friction Assy w/Detent ..... 112-10130-47 Gate Plate..... 102-11697-11 Pivot Pump ..... 112-10130-13 Boot ..... 112-10130-42 Black Knob..... 112-10130-44 Friction Assembly ..... 112-10130-46
702-04121-01	Control Mechanism Only .... 102-13201-01 Control Housing Only ... 502-20919-80
102-13201-01	Control w/Box ..... 702-04121-01 4" Stroke Bracket ..... 102-12976-01 Knob (2 ea) ..... 102-13201-02 30 Series Clevis ..... 102-07240-21 Friction Disk (4 ea) ..... 102-13201-18 Carriage Bolt (2 ea) ..... 102-13201-24 3" Stroke Bracket..... 102-13010-01 Control Box ..... 502-20919-80 Throttle Lever..... 102-13201-03 60 Series Clevis..... 06-1500-06 Belleville Washer (5 ea) .. 102-13201-19 Drum Lever ..... 102-13201-38
602-20357-01	Decal ..... 102-05612-62 40 Series Clevis ..... 042212 Knob ..... 102-13201-02 60 Series Clevis ..... 1050292

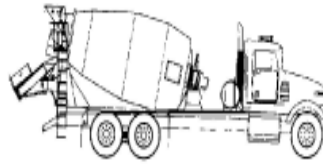

**CABLES & CONTROLS SECTION**

***Rex Controls***



Part Number	Related Parts & Information	
102-32064-11	Rebuilt .....	102-32064-11EX
	Rear Remote Control .....	102-32064-12
	Knob .....	102-32064-21
	Potentiometer .....	102-32064-POT
113-21371-01	Electronic Engine Units	
	Knob .....	102-13201-02
	Friction Disk (2 ea) .....	102-13201-18
	Carriage Bolt .....	102-13201-24
102-12034-02	Toggle Switch Pendant	
	Rebuilt .....	102-12034-02EX
102-32064-12	Cab Control .....	102-32064-11
	Knob .....	102-32064-21
	Smith .....	1090315
	Wire Harness .....	102-32064-14
	Replacement Board .....	102-32064-RB
	Clevis .....	06-1500-06
	Belleville Washer (3ea) ..	102-13201-19
	Lever .....	102-13201-38
	Wire Harness .....	102-32064-14
	Potentiometer .....	102-32064-POT



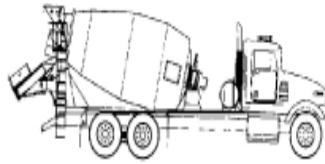

CABLES & CONTROLS SECTION

***ELCON1000AK Electric Pump Control Assembly***

